

TYPICAL ANCHOR/PIER
ASSEMBLY

-NOTES-

1. HOT DIP GALVANIZED PER ASTM A153-(LATEST REVISION).
2. SHAFT MATERIAL- HOT ROLLED ROUND-CORNERED-SQUARE (RCS) SOLID STEEL BARS PER ASTM A29: MINIMUM YIELD STRENGTH=70 KSI.
3. COUPLING BOLTS : 3/4" DIAMETER X 3" LONG HEX HEAD PER ASTM A325 TYPE 1
4. MANUFACTURER TO HAVE IN EFFECT INDUSTRY RECOGNIZED WRITTEN QUALITY CONTROLL FOR ALL MATERIALS AND MANUFACTURING PROCESSES.
5. ALL WELDING TO BE DONE BY WELDERS CERTIFED UNDER SECTION 5 OF THE AWS CODE D1.1.
6. SEE ICC EVALUATION SERVICE INC., EVALUATION REPORT NO. ESR-2794 FOR ALLOWABLE VALUES AND/OR CONDITIONS OF USE CONCERNING MATERIAL PRESENTED IN THIS DOCUMENT.
7. REFER TO SA150-0001 DRAWING FOR LEAD SECTIONS AND HELICAL EXTENSIONS.

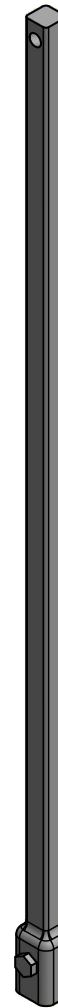

TORQUE STRENGTH* RATING-5,700 FT-LB
 ULTIMATE CAPACITY (COMPRESSION)-57 KIP
 * BASED ON A TORQUE FACTOR (Kt)=10
 PER ICC-ES AC358 SECTION 3.13.2
 NOMINAL TENSION STRENGTH (COUPLING BOLT)-70 KIP

ICC-ES
LISTED
ESR-2794

CHANCE [®]		HUBBELL [®] HUBBELL POWER SYSTEMS, INC.	
TITLE SS5 PLAIN EXTENSION			
SIZE C	CAT / PART / ASSY NO. C150-0008	DWG NO. SA150-0008	REV -
DO NOT SCALE THIS DRAWING	DRN BY BCT	DATE 04/27/16	SHEET 1 OF 1

CONFIDENTIAL: THIS DRAWING AND ITS CONTENTS ARE CONFIDENTIAL AND THE EXCLUSIVE PROPERTY OF HUBBELL POWER SYSTEMS. NO PUBLICATION, DISTRIBUTION, OR COPIES MAY BE MADE WITHOUT THE WRITTEN CONSENT OF HUBBELL POWER SYSTEMS. HUBBELL POWER SYSTEMS UNPUBLISHED ALL RIGHTS RESERVED UNDER THE COPYRIGHT LAWS.